

gelpole

For schools

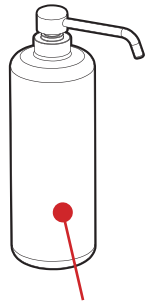

Children's Gelpole 1 Litre



1 Litre refillable bottle

High quality signage

Integrated instructions

Locking cap for pump Replacement

1 litre capacity

Gel Level indicator

Welded stainless steel frame

Foot pedal

Heavy steel base

Rubber feet

gelpole

Foot operated hand sanitiser

- Portable
- Indoor & outdoor use
- Weather proof
- 3 Year warranty
- New accessories launching soon

More info at www.gelpole.com



Gel Replacement.

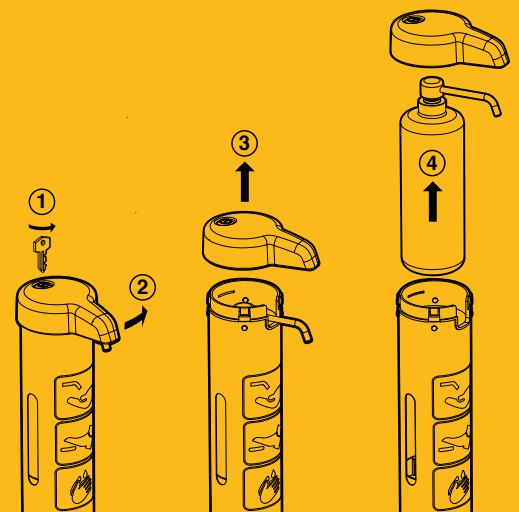

1 Litre



EGPK5



EGPHB

gelpole

Children's Gelpole Entry

Model No : EGPK5

Capacity : 1 Litre

Dimensions : H 775 W 98 mm

Weight : 4.6 kg

Pump : 50,000 activation, this is a replaceable part

Materials :

Cap and base cover: Nylon Plastic

Tube : 0.8 mm thick, brushed finish

201 Stainless steel

Frame : 3 mm 201 stainless steel

Carton : 1050 x 240 x 240 mm

Signage

Weight : 1.6 kg

Material : Styrene (GPPS)

Dimensions :

Pole with signage.Height : 1.6 m

Carton : 1010 x 320 x 75mm

Childrens Gelpole Entry

Inc.vat **RRP £ 249**

Heavy Base

Model No : EGPHB

Dimensions : H 6 W 430mm

Weight : 6.8kg

Materials : Steel plate powder coated.

Rubber feet

Carton : 450 x 450 x 40mm

Childrens Gelpole Entry + Heavy base

Inc.vat **RRP £ 299**



Tel: 028 92 666519

Email info@playservicesireland.co.uk

www.playservicesireland.co.uk